

Pentruder[®]

Pentruder MD1 drilling machine with HF-motor

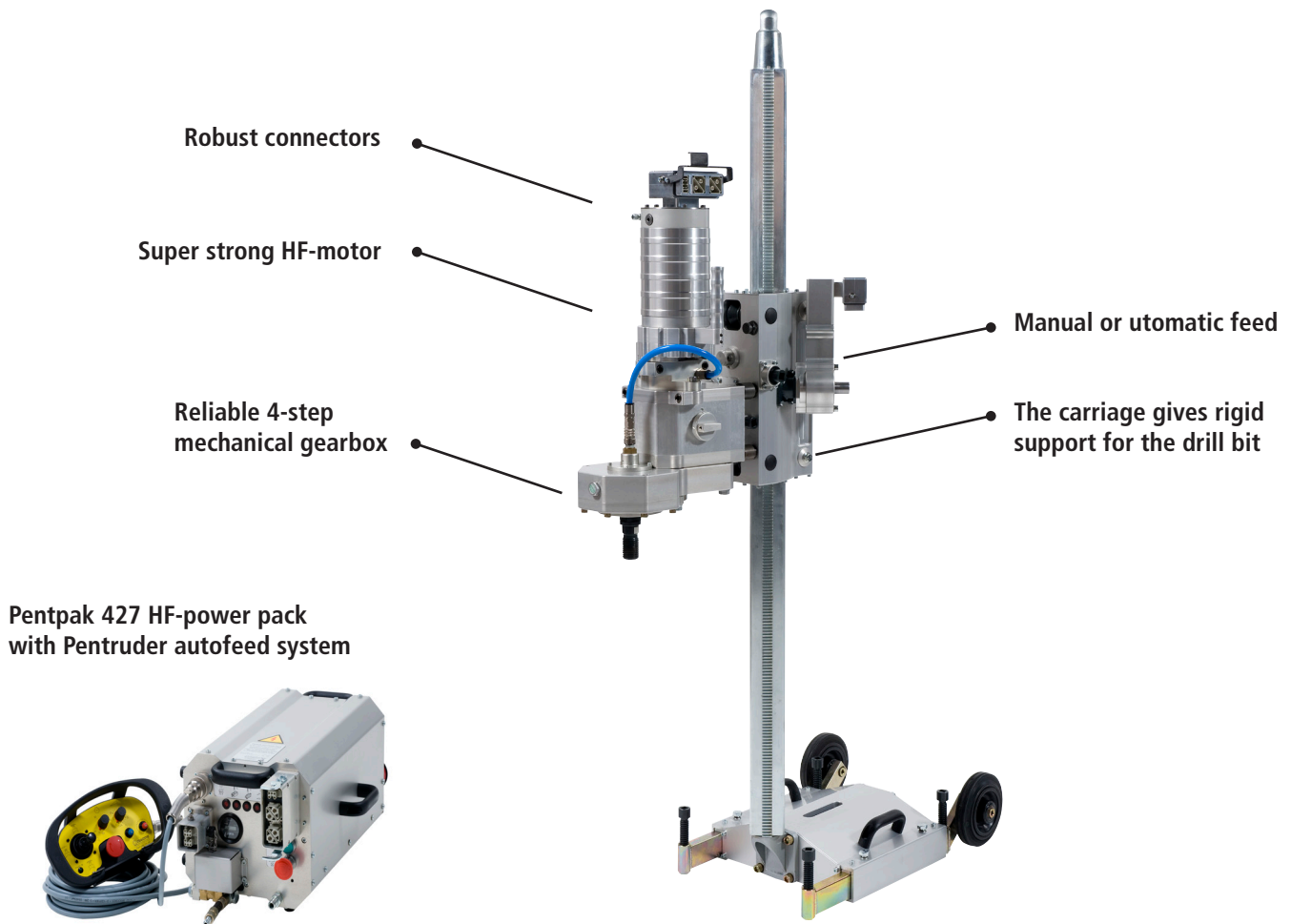

High performance - Reliability - Easy handling

- The Pentruder MD1 drill system is a versatile and very powerful drilling system for the professional concrete cutter.
- The carriage and spindle bearings are very stable and gives perfect control over the drill bit.
- The MG41 4-speed gearbox and ST2 or ST3 spindle unit offers a high torque and unbeatable performance.
- Use with the 15, 18 or 22 kW HF-motor.
- Max output power is 12 kW / 16 HP
- Max torque 2120 Nm with the 22 kW HF-motor and the low speed ST2 spindle unit.

Pentrunder MD1 drilling machine with HF-motor - Modules

Drill unit



15 kW HF-motor

18 kW HF-motor

22 kW HF-motor



HFMR-MG41 Adapter for MG41 gearbox



MG41 4-step gearbox



ST2 or ST3 Spindle unit for MG41 with 1-1/4" drill spindle



ST2 or ST3 Spindle unit for MG41 with QDC Quick Disconnect Coupling for drill bit



QDC drill bit adapters
QDC-1-1/4"*
QDC-84, 3 holes, PCD84
QDC-94, 9 holes, PCD94



Pentpak 427 HF-power pack with cables and remote control

Drill rig



HK-1 Hand crank

or



Knuckle bar 400 mm, 1/2"



Connector with ID-chip**



CE1-70 Carriage, manual feed



FE1 Friction clutch for CE1-70

or



PT-MD1 Electric feed unit for CE1-70



ERMD1 Extension adapter



CN-F/J column, Female/Male coupling/ Jack screw, 0.5, 1.5 m

or/ and



CN-F/M column, Female/Male coupling 0.5, 1.2, 1.5 m



RST-CN-U Rear support for male coupling

or



RST-CN-U Rear support for column universal



BE1 Base plate with fixed conical coupling

or



BE2 Base plate with adjustable conical coupling

or

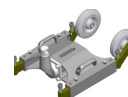

BE6 Base plate with cut outs and fixed conical coupling

* Other threads are available.

** Not necessary when PT-MD1 Electric feed unit is used.

Max drill bit Ø with carriage CE1-70

| | |
|---------------------------------|--------|
| - without extension adapter: | 600 mm |
| - One ERMD1 extension adapter: | 790 mm |
| - Two ERMD1 extension adapters: | 970 mm |

Technical data Pentpak 427, 422, 418 Pentpak (200), 218, 222

| | | |
|-----------------------|-------------|------------------|
| Input voltage: | 380 – 480 V | 200 – 230 V |
| Input frequency: | 50 – 60 Hz | (400) 50 – 60 Hz |
| Minimum fuse*: | 16 Ampere | 32 Ampere |
| Recommended fuse: | 40 Ampere | 80 Ampere |
| Recommended gen.size: | 45 kVA | 45 kVA |

Spindle speeds

| HF-motor: | 15 kW | | 18/22 kW | |
|---------------|---------|---------|----------|---------|
| Spindle unit: | ST2 | ST3 | ST2 | ST3 |
| 1st gear: | 0 - 80 | 0 - 160 | 0 - 55 | 0 - 115 |
| 2nd gear: | 0 - 125 | 0 - 260 | 0 - 90 | 0 - 180 |
| 3rd gear: | 0 - 215 | 0 - 445 | 0 - 150 | 0 - 315 |
| 4th gear: | 0 - 345 | 0 - 700 | 0 - 240 | 0 - 500 |

Torque in Nm

| HF-motor: | 15 kW | | 18 kW | | 22 kW | |
|---------------|-------|-----|-------|-----|-------|------|
| Spindle unit: | ST2 | ST3 | ST2 | ST3 | ST2 | ST3 |
| 1st gear: | 1450 | 700 | 1740 | 840 | 2102 | 1020 |
| 2nd gear: | 910 | 440 | 1100 | 530 | 1340 | 640 |
| 3rd gear: | 530 | 250 | 640 | 310 | 780 | 370 |
| 4th gear: | 330 | 160 | 400 | 190 | 490 | 230 |

Tractive AB reserves the right to change technical data without previous notice.

Pentrunder®

Concrete Cutting Systems

Tractive AB, Gjutargatan 54, 78170 Borlänge, Sweden
Tel: +46 (0)243 221155, Fax: +46 (0)243 221180
E-mail: info@tractive.se, www.pentrunder.com